

# CHI<sup>®</sup>

## USE AND CARE MANUAL

Before operating the iron, please read these instructions carefully and keep them for future reference.



# IMPORTANT SAFETY INSTRUCTIONS

When using electrical appliances, basic safety precautions should always be followed to reduce the risk of fire, electric shock, and/or injury to persons, including the following:

1. Read all instructions.
2. This appliance is not intended for use by persons (including children) with reduced physical, sensory, or mental capabilities, or lack of experience and knowledge, unless they are closely supervised and instructed concerning use of the appliance by a person responsible for their safety.
3. Close supervision is necessary when any appliance is used by or near children. Children should be supervised to ensure that they do not play with the appliance.
4. Only use an iron for its intended use.
5. To avoid the risk of electric shock, do not immerse the iron in water or other liquids.
6. Always turn the iron to min before plugging or unplugging the iron from the electrical outlet. Never pull on the cord to disconnect the iron from the electrical outlet; instead, grasp the plug and pull on the plug to disconnect the iron.
7. Do not let the cord touch hot surfaces. Let the iron cool completely before putting the iron away. Coil the cord loosely around the iron for storing.
8. Always disconnect the iron from the electrical outlet before filling the iron with water, emptying the water from the iron, and when the iron is not in use.

9. Do not operate the iron with a damaged cord or in the event the iron has been dropped or damaged or there are visible signs of damage or it is leaking. To avoid the risk of electric shock, do not disassemble the iron. Take it to a qualified serviceman for examination and repair. Incorrect assembly might result in a risk of electric shock when the iron is used after reassembly.
10. The iron must be used and rested on a stable surface.
11. When placing the iron on its heel rest, ensure that the surface on which the heel rest is placed is stable.
12. Do not leave the iron unattended while the iron is connected or on an ironing board.
13. Burns can occur from touching hot metal parts, hot water, or steam. Use caution when you turn a steam iron upside down—there might be hot water in the reservoir.
14. To avoid a circuit overload, do not operate an iron on the same circuit with another high-wattage appliance.
15. If an extension cord is absolutely necessary, a cord with an ampere rating equal to or greater than the maximum rating of the iron shall be used. A cord rated for less amperage can result in a risk of fire or electric shock due to overheating. Care shall be taken to arrange the cord so that it cannot be pulled or be tripped over.

## **SAVE THESE INSTRUCTIONS**

## Parts and Features

1. Spray Nozzle
2. Water Fill Door
3. Spray (☂) and Steam (☁) Buttons
4. Self-Clean Button
5. Fabric Temperature Indicators
6. Adjustable Steam Lever
7. Temperature Setting Dial
8. Handle
9. Cord
10. Power Indicator Light
11. Heel Rest
12. Water Window
13. MAX Fill Line
14. Titanium Ceramic Soleplate

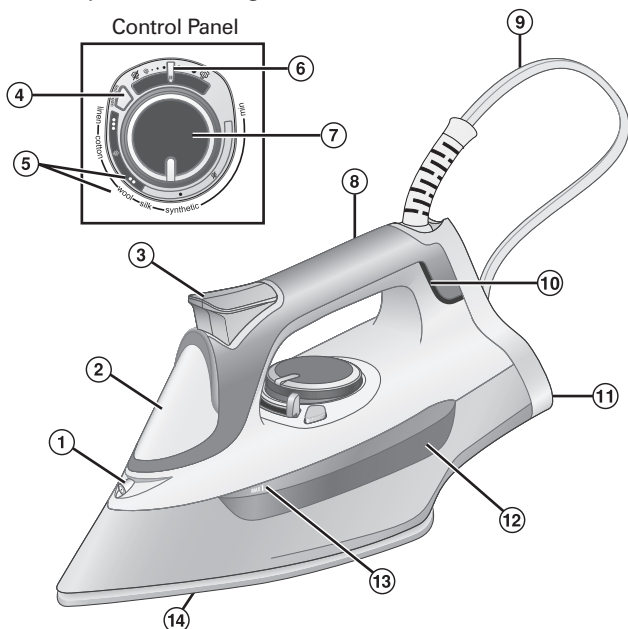

## How to Dry and Steam Iron

**⚠ CAUTION Burn Hazard:** Attempting to steam iron on a lower temperature setting or failing to allow the iron to preheat for 2 minutes can result in hot water dripping from the soleplate.

- 1. To Steam Iron:** Make sure iron is unplugged.

Lift Water Fill Door and add water to the MAX Fill Line through the opening. If you have extremely hard water, alternate between tap water and distilled water for use in the iron.

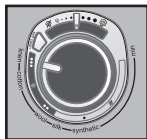

Press to snap cover closed. Plug into outlet and the red Power Indicator Light comes on. Turn the Temperature Setting Dial to select temperature setting. Linen, cotton, or wool are recommended for steaming. Move Adjustable Steam Lever to desired amount of steam.

**To Dry Iron:** Plug into outlet. Turn Temperature Setting Dial to select temperature setting.

- 2.** Preheat 2 minutes to reach desired temperature. You are now ready to iron.
- 3.** To turn iron off, move Adjustable Steam Lever to  (Dry Iron) and turn Temperature Setting Dial to min. Unplug.

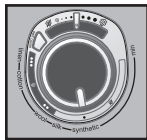

## POSITION SENSING/AUTO SHUTOFF

The iron will turn off automatically when left in the following positions. The Auto Shutoff time varies based on the iron's position.

### IRON POSITION

Resting on soleplate



Resting on either side



Resting on heel



### MOTIONLESS TIME

60 seconds

60 seconds

30 minutes

**NOTE:** Tilting the iron more than 30 degrees will reset the Auto Shutoff sensor.

## Tips for Best Ironing Results

### FABRIC FACTS AND LABELS:

Every fabric is different and should be treated accordingly. The label inside clothing or linens should recommend fabric care instructions that include ironing treatment. As a general rule, these instructions should be followed. If the fabric is a blend, use a low temperature setting. If you do not know what the content of the fabric is, use the lowest temperature first and test on an inside seam.

### PREPARE TO IRON:

1. Cover your ironing board with a padded, heat-resistant cover. Brush or wipe off any dust, dirt, or debris so it doesn't transfer to clothing.
2. To set the height of the ironing board, stand with your elbows bent at right angles; then drop your hands slightly so that your arms are in a comfortable position. Set the height of your ironing board to this height.

## Tips for Best Ironing Results (cont.)

3. Check the soleplate for mineral deposits or scorched material before you begin ironing. Follow “Soleplate Care” instructions on page 8.

### **FAST FACTS:**

- Always iron with a lengthwise motion. Ironing in a circular motion may stretch fabric.
- Natural fibers such as cotton and linen should be ironed slightly damp for faster, easier ironing. If they are completely dry, use maximum steam while ironing or mist them with water prior to ironing.
- Any portion of a garment that has two layers of fabric such as pockets, seams, collars, and cuffs should be ironed inside out first.
- To press a collar, iron from the points in using small strokes of the iron. After wrinkles are removed, crease the collar into place by hand. Treat French cuffs similarly, gently creasing by hand after ironing.

### **IRONING VERSUS PRESSING:**

- You may have heard the terms “ironing” and “pressing” used interchangeably, but they are actually quite different. When ironing, you slide the iron back and forth over fabric. When pressing, the iron is placed and held on the fabric in one spot, lifted up, and this process is repeated until the areas that need attention are smooth. A “pressing” technique is helpful to avoid stretching fabrics.
- A pressing cloth can help reduce unwanted “shine” on fabrics. You can purchase a pressing cloth in the laundry care section, or a clean white dish towel or 100% cotton pillowcase works equally well. You do not need to increase the recommended iron temperature when using a pressing cloth.

## Care and Cleaning

1. Unplug and allow iron to cool.
2. To empty water from iron, lift Water Fill Door and slowly tilt pointed end of iron over a sink until all the water has poured out.
3. Store iron on the Heel Rest. **NOTE:** Use the Self-Clean function following each use of the steam function to keep the steam vents clear of any mineral buildup. Add water to the iron. Turn the Temperature Setting Dial to linen (•••) and preheat for 2 minutes. Then, turn the Temperature Setting Dial to min and unplug. Hold the iron over a sink. Press and hold the Self-Clean Button. Once steaming stops, release the button and tilt iron forward and backward to ensure any remaining water exits the vents on the soleplate. Allow iron to cool before storing.

## Soleplate Care

The Self-Clean function cleans the steam holes, but will not remove residue from the flat surface of the soleplate. To clean an iron's soleplate, preheat the iron to the linen (•••) setting and iron over a damp, 100% cotton cloth. This creates heavy steam that transfers residue from the soleplate to the cloth.

**NOTE: Care should be used while cleaning; steam can burn.**

### NOTES:

- Never iron over zippers, pins, metal rivets, or snaps since these may scratch the soleplate.
- Do not use abrasive cleansers or metal scouring pads.



## Troubleshooting

### Iron won't heat.

- Plug iron into a working outlet.
- Select a temperature.
- Move or tilt the iron to reset.

### Water is leaking.

- Too much water is in the Water Tank.
- Adjust steam to a lower setting.
- Steam button has been pressed while the iron was cold. Select a temperature and let iron preheat for 2 minutes.
- If dry ironing, make sure the Adjustable Steam Lever is in the  (Dry Iron) position.

### Iron won't steam.

- Ensure there is water in the Water Tank.
- Move the Adjustable Steam Lever to the  (Steam) position?
- Preheat for 2 minutes.
- Anti-drip feature will not allow steam when temperature setting is in the dry range.

### Twisted cord.

- If the iron cord should become twisted, unplug iron and let cool. Hold iron cord in the middle of entire length. Let plug and iron dangle freely until cord uncoils. This will extend the life of the iron cord.

## Notes

## Notes (cont.)

## Limited Warranty

This warranty applies to products purchased and used in the U.S. This is the only express warranty for this product and is in lieu of any other warranty.

This product is warranted to be free of defects in material and workmanship for a period of two (2) years from the date of original purchase. During this period, your exclusive remedy is repair or replacement of this product or any component found to be defective, at our option; however, you are responsible for all costs associated with returning the product to us and our returning a product or component under this warranty to you. If the product or component is no longer available, we will replace with a similar one of equal or greater value.

This warranty does not cover glass, filters, wear from normal use, use not in conformity with the printed directions, or damage to the product resulting from accident, alteration, abuse, or misuse. This warranty extends only to the original consumer purchaser or gift recipient. Keep the original sales receipt, as proof of purchase is required to make a warranty claim. This warranty is void if the product is used for other than single-family household use or subjected to any voltage and waveform other than as specified on the rating label (e.g., 120 V ~ 60 Hz).

We exclude all claims for special, incidental, and consequential damages caused by breach of express or implied warranty. All liability is limited to the amount of the purchase price. **Every implied warranty, including any warranty of merchantability or fitness for a particular purpose, is disclaimed except to the extent prohibited by law, in which case such warranty is limited to the duration of this written warranty.** This warranty gives you specific legal rights. You may have other legal rights that vary depending on where you live. Some states do not allow limitations on implied warranties or special, incidental, or consequential damages, so the foregoing limitations may not apply to you.

To make a warranty claim, do not return this appliance to the store. Please call CHI Garment Care 1.844.882.9038 in the U.S. or visit [www.chisteam.com](http://www.chisteam.com) in the U.S. For faster service, locate the model, type, and series numbers on your appliance.